

## Rotulas SI

### BEF12-20-501-DURBAL - BEF12-20-501-DURBAL

<https://www.123rodamiento.mx/rodamiento-cojinete/rotulas/si/bef12-20-501-durbal>

#### BEF12-20-501



**rod end housing:**  
forged steel, tempered, surface galvanized, free of Cr VI

**joint ball:**  
ball bearing steel, hardened and ground, surface superfinished and chromium plated

**race:**  
nylon / teflon / glass fibre compound

**tolerances:**  
see page 10

**DURBAL® heavy-duty rod ends with integral spherical plain bearing**

**female thread:**  
maintenance free, adapter sizes according to DIN ISO 12240-4, series K, thread according to ISO 8139

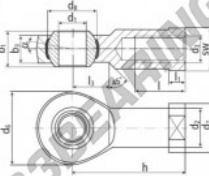

order number		measurements [mm]									
type	specification	d1	d2	d3	d4	d5	d6	d7	d8	h	l
BEF 12	-20 -501	12	17,5	M 12	32	22	22,17	16	12,0		
measurements [mm]		weight		basic load rating							
type	h	l	l1	l2	l3	SW	α1°	α2°	[kg]	C	stat. C0
BEF 12	50	22	6,5	16	19	13,0	8,0	0,109	12425	33400	

## CARACTERÍSTICAS DEL PRODUCTO

Marca	DURBAL
N° Ean13	3663952508085
Diámetro interior	12 mm
Diámetro exterior	32 mm
Espesor	16 mm
Tipo	SI
Peso	109 g
Hilo	Rosca derecha
Lubricación	sin
Envasado	1

[contacto@123rodamiento.mx](mailto:contacto@123rodamiento.mx)

+34 911 436 830

CRT4 de Lesquin 60 Rue Du Haut De Sainghin 59273 Fretin FRANCE